

HMGJB

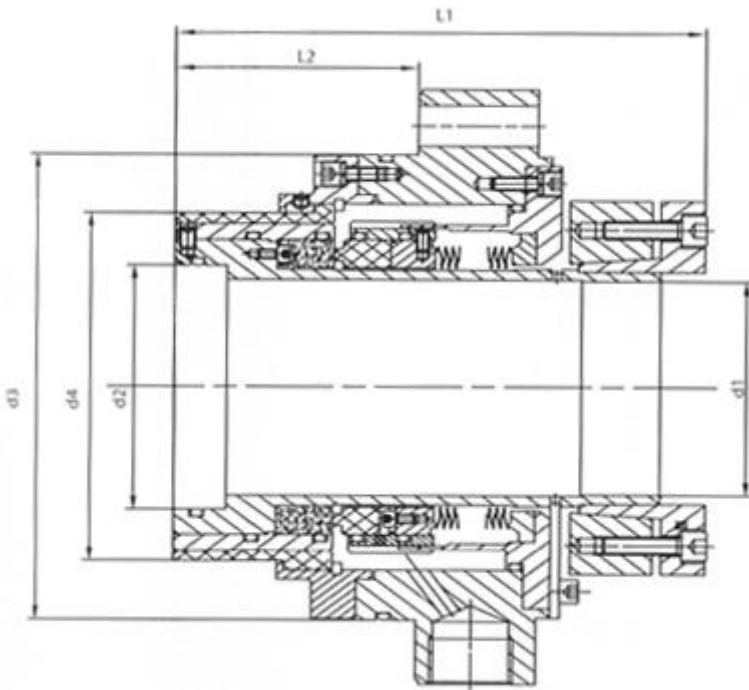

- ▲ Cartridge
- ▲ Balanced
- ▲ Metal Bellows
- ▲ Equipped with Cooling System

Mechanical seals of the HMGJB series are designed for boiler feed pump in thermal power stations

Type	d1	d2	d3	d4	L1	L2
HMGJB-60	60	65	136	120	145	112
HMGJB-70	70	76	145	129	145	112
HMGJB-82	82	88	156	142	145	112
HMGJB-91	91	96	162	150	145	112
HMGJB-92	92	96	197	174	145	112
HMGJB-96	96	96	197	174	145	112
HMGJB-99	99	105	190	161	145	112
HMGJB-104	104	110	200	159	154	126
HMGJB-109	92.5	92	180	178	185	150
HMGJB-115	101	115	215	170	172	145
HMGJB-120	120	120	210	195	176.5	145
HMGJB-125	111	125	215	170	166	145
HMGJB-125A	111	125	215	170	166	145
HMGJB-131	131	131	210	195	176.5	145
HMGJB-131S	121	131	255	229	190	145

d=60~300mm

$p \leq 4.0 \text{ MPa}$

$t \leq 250^\circ \text{C}$

$v \leq 50 \text{ m/s}$